

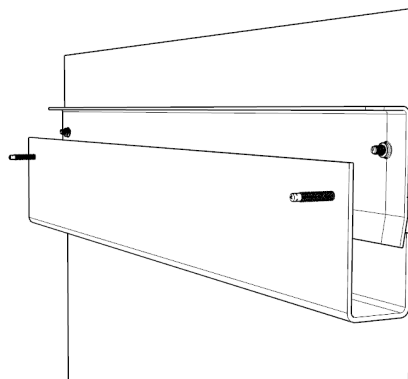
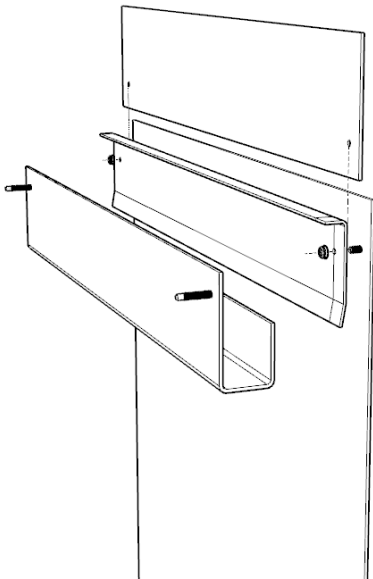

Plate Panel System offers a uniquely flexible metal facade system, compatible with most Zahner Surface offerings in addition to other common metals and finishes, providing an expansive pallet of materials and finishes from which to select for you project. Variation on Zahner's Plate Panel systems include horizontal, vertical and stacked.

Zahner's Plate Panel design variations include horizontal and vertical orientations to allow for applications not only interior but exterior as well.

Applications:

- Interior and exterior
- New construction, retrofit, or add-on



*Rectangular panels shown are for reference.
Other unique profiles are available
by contacting Zahner.*

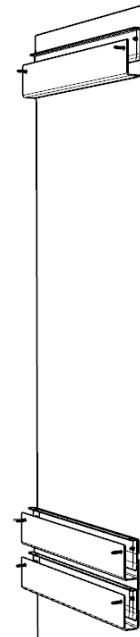





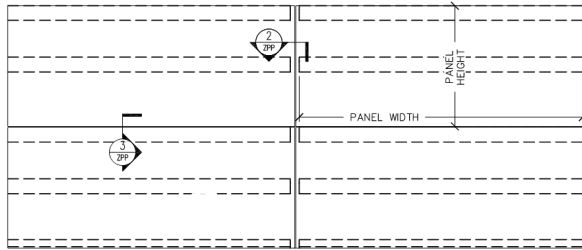
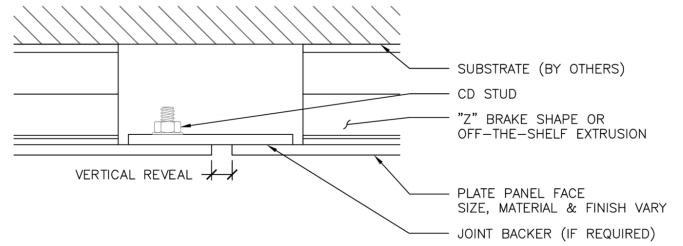

Plate Panel Material and Finish Offerings:

<p>Solanum Steel™ → Pre-Oxidized Weathering Steel</p> 	<p>Oscura™ Blackened Steel → Patinated Steel</p> <p>INTERIOR ONLY</p> 	<p>Spectura™ Steel → Iridescent Finish on Steel</p> <p>INTERIOR ONLY</p> 	<p>Angel Hair® → Diffuse finish on Stainless Steel</p> 	<p>GB-60™ → Diffuse finish on Stainless Steel</p> 
---	---	--	--	---



Panel Elevation



Vertical Joint - Plan Section

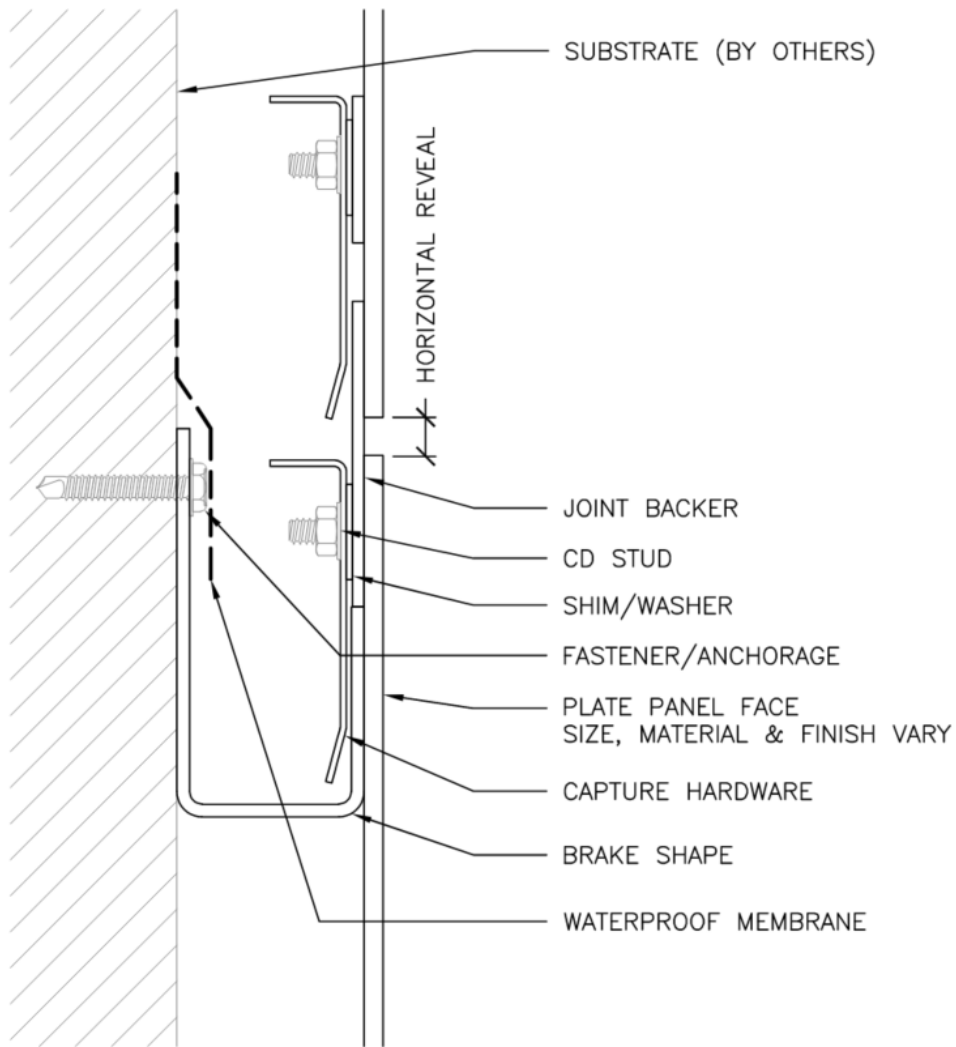

Horizontal Joint - Elevation Section

The following charts are provided for preliminary design only. Please consult Zahner's licensed engineers to verify your project's specific requirements.

Chart indicates the maximum pattern or panel width relative to the desired material and project design pressures.

Maximum panel length is typically 12'.

System Weight: 3-9lbs / sq. ft. depending on specific configuration

